

# Speed-Control Plug'n'Dose AM version

## Dosing technology Dosing system

```

CASE 5   UF=1           GOSUB4 ' Call MenuOptions ' Print out
GOSUB4  UFO ' Call MenuOptionsUE=0 ' Print out Menu option
UE=1    q=UGA         ' Check Go switch
UEO    WHILE q<700    UF=1
UF=1    UE=0         ' Need to toggel Port E to show
UFO    q=UGA         q=UGA ' Check G
q=UGA  IF UGI==0     ' Check G
WHILE q<700 WHILE UGI==0 LOOP UGA
q=UGA  GOSUB17      ' Run that Demo subroutine sle
IF UGI=ENDIF      ' IF Go is slected WHILE UGI==0 LOOP
WHILE UE=1==0 LOOP GOSUB16 ' Run that Dem
GLOOP5           ' Run that Dem5 subroutine
E BREAK          LOOP
  
```



### PRODUCT DESCRIPTION

The preeflow Speed Control 'plug'n'dose' AM control unit has been developed specifically for applications in automation.

### OPERATING PRINCIPLE

Microprocessor-controlled. External signals such as the dosing speed and dosing time of a superior control unit, for example an SPS, are processed further and control the eco-PEN's dosing process.

The integrated motor monitoring as overload protection for the dispenser can be processed as an error message.

Fig.: Front view

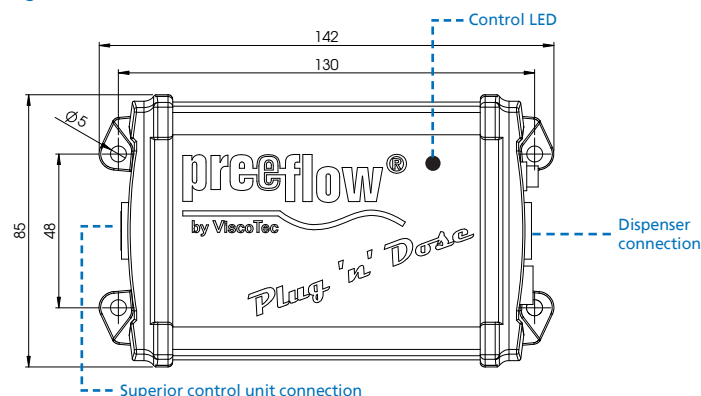

Connection

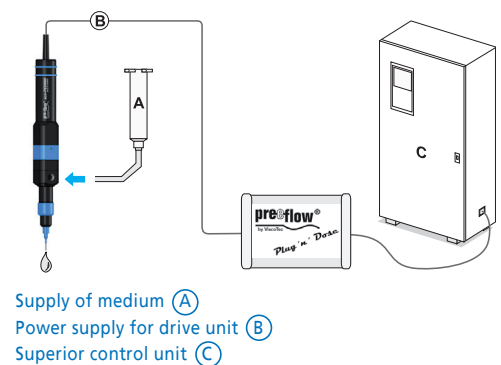

### TECHNICAL DATA

Dimensions (W x H x D):	142 x 85 x 50 mm
Mounting:	4 holes / 5 mm, hole interval 130 x 48 mm
Weight	Approx. 260 g
Supply voltage:	24 V DC
Mains adapter:	Not included
Consumption / rating:	100 VA / 2.7 A
Operating conditions:	+10°C to +40°C (non-condensing), air pressure 1 bar
Storage conditions:	Dry / dust-free, -10°C to +40°C

**preeflow**<sup>®</sup>  
by ViscoTec

info@preeflow.com | www.preeflow.com

© ViscoTec Pumpen und Dosiertechnik GmbH  
02/10 – Subject to technical changes,  
typographical errors and misprints reserved.